

UTECH380 (GEARLESS)

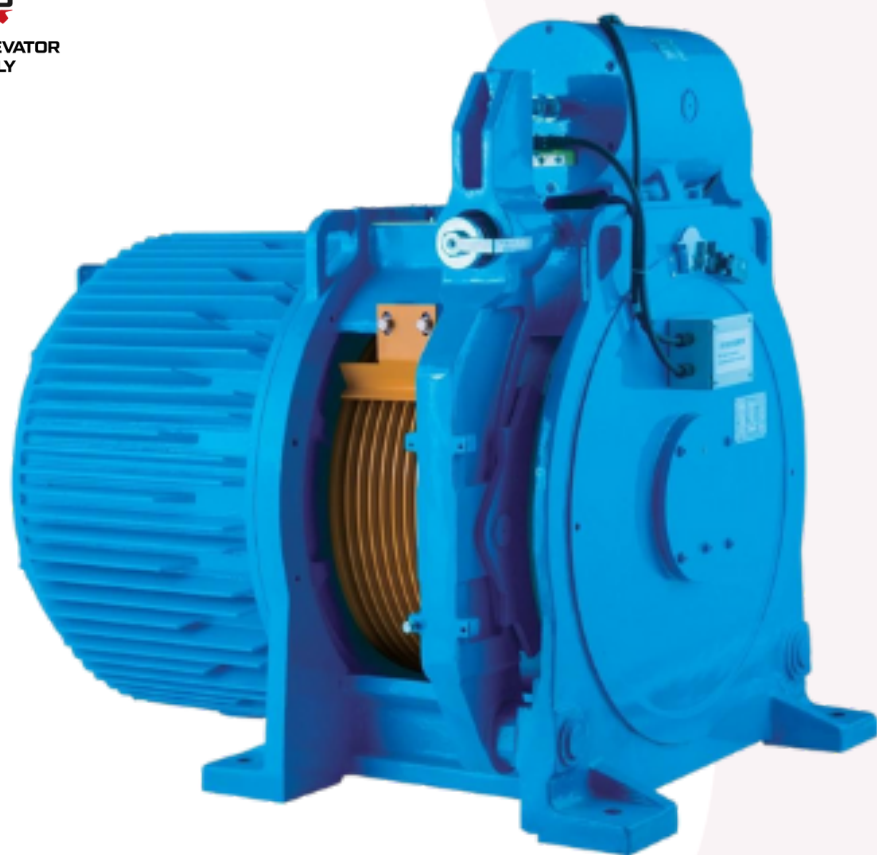

NEXUS ELEVATOR
SUPPLY



Product Specs

Traction ratio: 1:1, 2:1

Rated capacity: 1350, 1600, 2000, 2500, 3000, 3500, 4000kg

Rated elevator speed:

1.0, 1.5, 1.75, 2, 2.5, 3.0m/s

Max. lifting height: 120m

Max. shaft load: 10000kg

Applicable converter: 3 phase 400V

Brake voltage: DC200V for Brake opening, and DC100V for brake holding

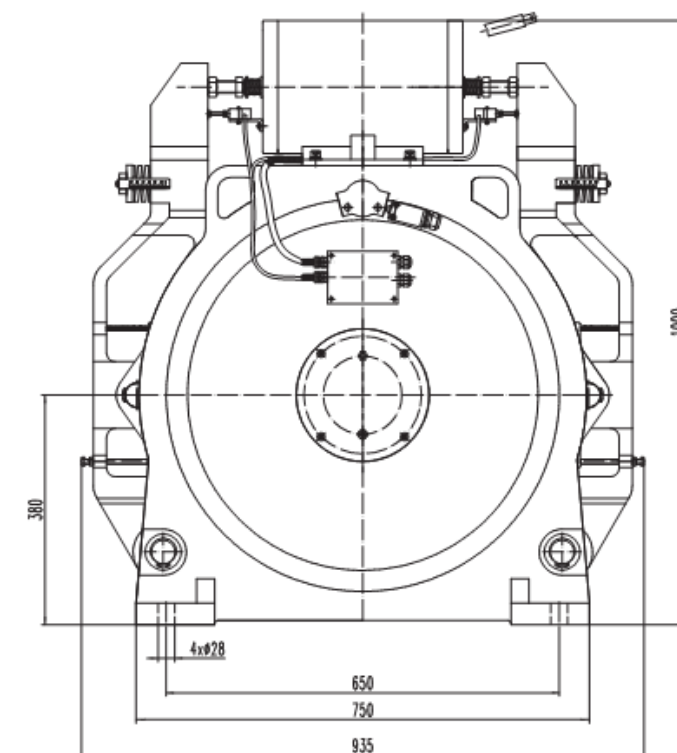
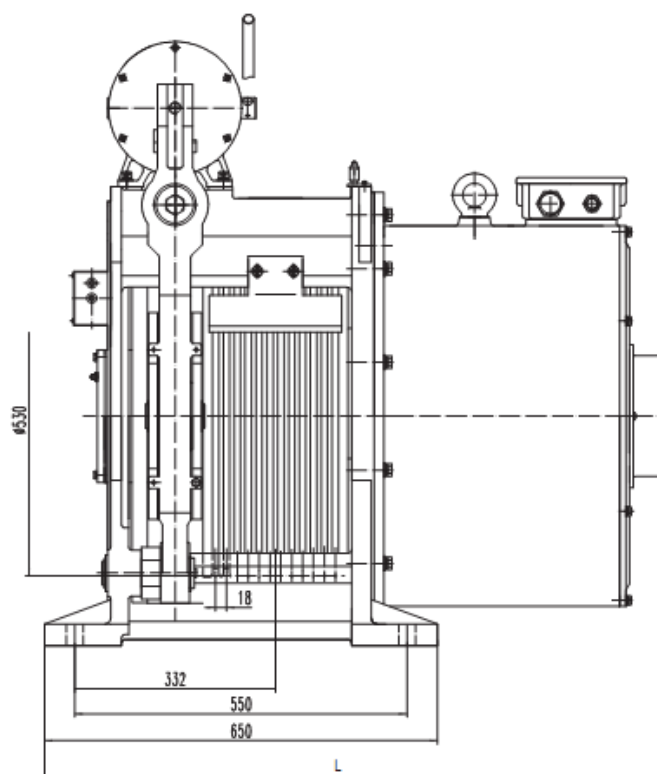

型号 Type	规格 Specification	曳引比 Traction Ratio	速度 Speed (m/s)	载重 Load (kg)	功率 Power (kW)	转速 Rev (r/min)	频率 Frequency (Hz)	电流 Current (A)	转矩 Torque (N·m)	绳径 Rope	L	自重 Weight (kg)	推荐提升高度 Recommended lifting height (m)
WTFF	380-10-1350-1	1:1	1.0	1350	8.8	36	9	23.5	2324	10×Ø13	1050	1220	45
	380-15-1350-1		1.5		13.2	54	13.5	34					70
	380-17.5-1350-1		1.75		15.4	63.2	15.8	37.4					80
	380-20-1350-1		2.0		17.5	72	18	44					80
	380-25-1350-1		2.5		21.9	90	22.5	51.5					120
	380-30-1350-1	1:1	3.0	1600	26.3	108	27	61	2754	11×Ø13	1050	1270	120
	380-10-1600-1		1.0		10.4	36	9	27.5					45
	380-15-1600-1		1.5		15.6	54	13.5	40					70
	380-17.5-1600-1		1.75		18.2	63.2	15.8	43.4					80
	380-20-1600-1		2.0		20.8	72	18	51.5					80
	380-25-1600-1	1:1	2.5	2000	26.0	90	22.5	61	3443	12×Ø13	1100	1480	120
	380-30-1600-1		3.0		31.2	108	27	72					120
	380-10-2000-1		1.0		13.0	36	9	33					45
	380-15-2000-1		1.5		20.8	54	13.5	51					60
	380-17.5-2000-1		1.75		22.8	63.2	15.8	55					60
	380-20-2000-1	2:1	2.0	2500	26.0	72	18	62	2150	10×Ø13	1050	1220	70
	380-6.3-2500-2		0.63		10.2	45.6	11.4	24					30
	380-10-2500-2		1.0		16.2	72	18	39.5					45
	380-16-2500-2		1.6		26.0	115.2	28.8	60					70
	380-20-2500-2		2.0		32.5	144	36	76					80
	380-6.3-3000-2	2:1	0.63	3000	12.3	45.6	11.4	31	2586	11×Ø13	1050	1270	30
	380-10-3000-2		1.0		19.5	72	18	46					45
	380-16-3000-2		1.6		31.2	115.2	28.8	72					70
	380-20-3000-2		2.0		39.0	144	36	89					80
	380-6.3-3500-2	2:1	0.63	3500	14.3	45.6	11.4	36	3010	11×Ø13	1100	1270	30
	380-10-3500-2		1.0		22.7	72	18	54					45
	380-16-3500-2		1.6		36.4	115.2	28.8	84					70
	380-20-3500-2		2.0		45.4	144	36	103					80
	380-6.3-4000-2	2:1	0.63	4000	16.4	45.6	11.4	41	3448	12×Ø13	1100	1480	30
	380-10-4000-2		1.0		26.0	72	18	62					45
	380-16-4000-2		1.6		41.6	115.2	28.8	95					60
	380-20-4000-2		2.0		51.9	144	36	118					70